

PART NO.	A 104675-001	REV	ECO	DATE	APP
		A	100878	09-15-14	TLM

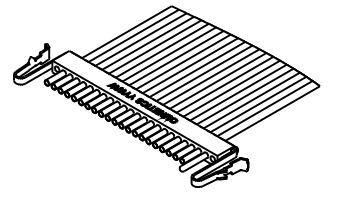

ACTUAL SIZE EXCLUDING WIRE LENGTH

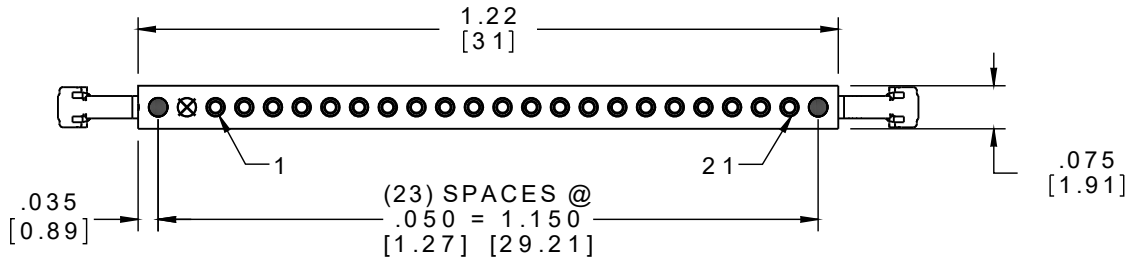
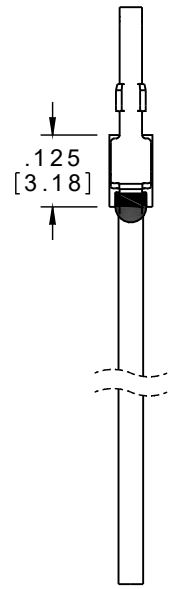
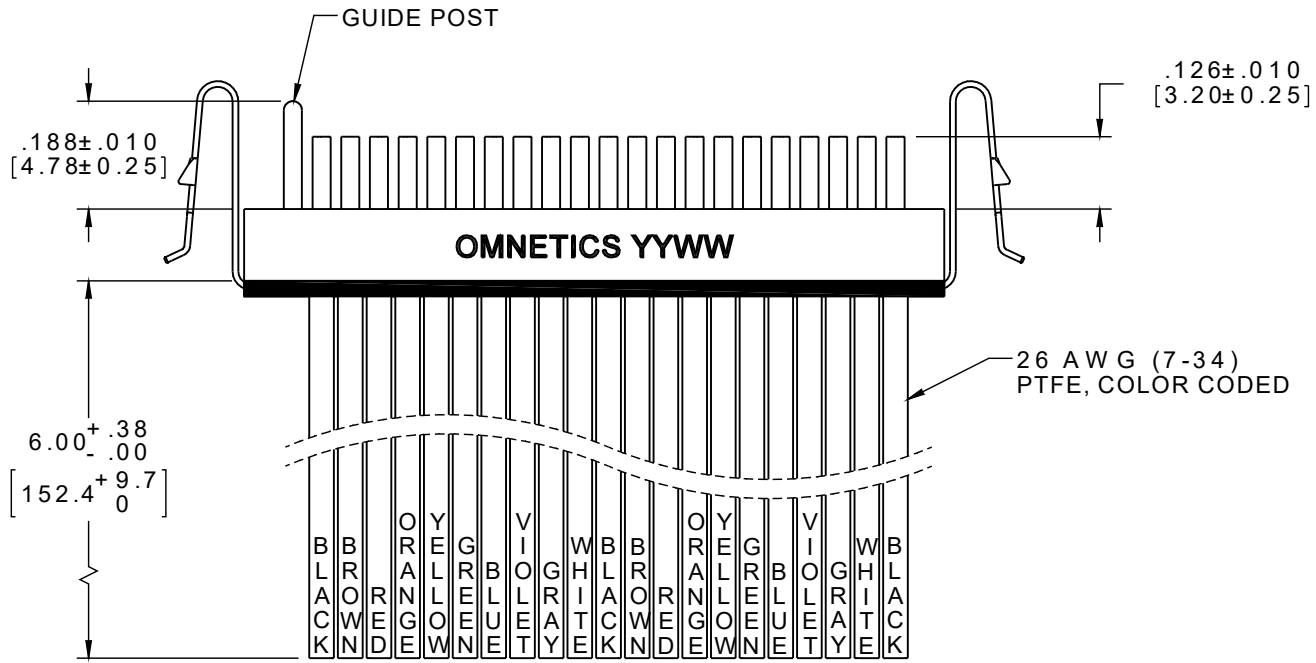

SOCKET #	COLOR
1, 11, 21	BLACK
2, 12	BROWN
3, 13	RED
4, 14	ORANGE
5, 15	YELLOW
6, 16	GREEN
7, 17	BLUE
8, 18	VIOLET
9, 19	GRAY
10, 20	WHITE

B B O R A Y E G V W B B O R A Y E G V W B
 L L R R A Y E G V W B B O R A Y E G V W B
 A A O O R R E L L E U I O H L R R E L L E U I O
 C C W W N D I E W N E T A T C K N D I E W N E T A T C K
 K K N D I E W N E T A T C K N D I E W N E T A T C K

NOTE:
DIMENSIONS IN [] ARE IN MILLIMETERS UNLESS OTHERWISE NOTED AND ARE FOR REFERENCE ONLY

SSB SLDW	THIRD ANGLE	THIS DRAWING CONTAINS CONFIDENTIAL AND PROPRIETARY INFORMATION WHICH IS THE PROPERTY OF OMNETICS CONNECTOR CORP. THIS DOCUMENT MAY NOT, IN WHOLE OR IN PART, BE DUPLICATED, OR DISCLOSED FOR ANY PURPOSE, WITHOUT WRITTEN PERMISSION FROM OMNETICS CONNECTOR CORP.	
	-TOLERANCES- UNLESS OTHERWISE NOTED DIMENSIONS IN INCHES	DFTM. JMJ	DATE 02-28-14
	2 PL DEC ± .01	CHK'D.	DATE
	3 PL DEC ± .005	APP'D.	DATE
	4 PL DEC ± .0005	TITLE: (21) SOCKET FEMALE SINGLE ROW CONNECTOR W/LATCHES & GUIDE POST	
	ANGLES ± 1°		

OMNETICS
CONNECTOR CORPORATION
7260 COMMERCE CIRCLE EAST
MINNEAPOLIS, MN 55432
WWW.OMNETICS.COM

CAGE CODE 61873	
DWG NO. A 104675-001	
SHEET 1 OF 1	REV A
SCALE: 3:1	